

CATM3

Terminal Type - CATM3, Feed Through Terminal Block, nominal voltage: 1100 V, nominal current: 32 A, Rated cross-section - 4.0 mm², connection method: Bolt Connection - Screwdriver Operated, number of connections: 2, cross-section: 2.5 mm² - 4 mm², mounting type: TS32

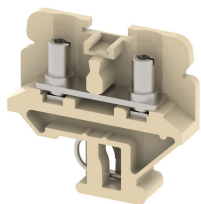

Approvals

CE

General Information

Product Name	CATM3
Connection Method	Bolt Connection
Rating	1100 V/32 A/4 mm ² /0.5 Nm
HSN Number	85389000
Standard Packing Qty(in No)	50
Country Of Origin	India
Screw thread	M3

Dimensions & Weight

Width	10 mm	0.39 inch
Length	46 mm	1.81 inch
Height	42 mm	1.65 inch
Weight of std. Packing Unit	0.97 Kg	

Material Data

Insulating Material	Melamine
Standard Colour	Khakhi
Colour Variants	Red , Yellow , Blue , Black , Green ,

Rated Conductor Size

Conductor cross section flexible min	2.5 mm ²
Conductor cross section flexible max	4 mm ²
Conductor cross section solid min	2.5 mm ²
Conductor cross section solid max	4 mm ²



Ratings - IEC

Connection in acc. with standard	IEC 60947-7-1
Nominal Voltage U_n	1100 V
Nominal Current I_n	32 A
Nominal cross section	4 mm ²
Short-time current	0.48 kA
Rated surge voltage	8 kV
Degree of pollution	3

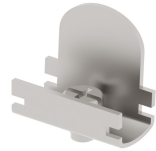
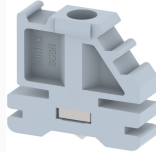
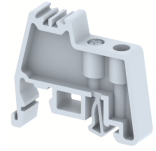
Product Accessories

Cover Profile		
PCCM20NV	Width : 20.00 mm Thickness : 1.00 mm Length : 45.50 mm	
PCCM30NV	Width : 30.00 mm Thickness : 1.00 mm Length : 45.50 mm	
PCC3NV	Width : 300.00 mm Thickness : 1.50 mm Length : 48.50 mm	
DIN Rail Perforated		
CHS	Height : 15.00 mm Width : 32.00 mm Thickness : 1.50 mm	
End Clamp		
SCS	Height : 26.90 mm Length : 21.00 mm	
SCSN	Height : 31.00 mm Width : 8.40 mm Length : 27.00 mm	
SCUP	Height : 34.00 mm Length : 44.75 mm	
SCUSL	Height : 41.10 mm Width : 8.00 mm Length : 47.50 mm	

End Clamp		
SCUDD	Height : 50.00 mm Width : 10.00 mm Length : 55.60 mm	
SCUN	Height : 35.50 mm Width : 9.50 mm Length : 50.60 mm	
End Cover		
EPS4NV	Height : 28.50 mm Width : 2.50 mm Length : 46.00 mm	
Insertion Bridge		
ASL1-2W	Width : 16.00 mm Pitch : 10.00 mm Length : 22.50 mm	
ASL1-10W	Width : 96.00 mm Pitch : 10.00 mm Length : 22.50 mm	
ASL1-3W	Width : 26.00 mm Pitch : 10.00 mm Length : 22.50 mm	
ASL1-4W	Width : 36.00 mm Pitch : 10.00 mm Length : 22.50 mm	
ASL1-5W	Width : 46.00 mm Pitch : 10.00 mm Length : 22.50 mm	
Marker For Terminal Blocks		
LABEL KN6.5	Width : 6.70 mm	
Partition Plate		
KBZF	Height : 65.00 mm Width : 1.50 mm Length : 65.00 mm	

Marker carriers		
GMC	Height : 48.00 mm Width : 39.00 mm Thickness : 1.00 mm Length : 38.00 mm	
SCUDDMLH	Height : 71.50 mm Width : 10.00 mm Length : 55.60 mm	
SCUNMLH	Height : 53.50 mm Width : 9.50 mm Length : 50.60 mm	