

CATM4NV

Terminal Type - CATM4NV , Feed Through Terminal Block , nominal voltage: 1100 V, nominal current: 57 A, Rated cross-section - 10 mm², connection method: Bolt Connection - Screw driver operated , number of connections: 2, cross-section: 2.5 mm² - 10 mm² , mounting type : TS32

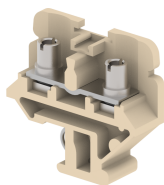

Approvals

CE

General Information

Product Name	CATM4NV
Connection Method	Bolt Connection
Rating	1100 V/57 A/10 mm ² /1.2 Nm
HSN Number	85389000
Standard Packing Qty(in No)	50
Country Of Origin	India
Screw thread	M4

Dimensions & Weight

Width	13 mm	0.51 inch
Length	46 mm	1.81 inch
Height	42 mm	1.65 inch
Weight of std. Packing Unit	1.26 Kg	

Material Data

Insulating Material	Melamine
Standard Colour	Khakhi
Colour Variants	Red , Yellow , Blue , Black , Green ,

Rated Conductor Size

Conductor cross section flexible min	2.5 mm ²
Conductor cross section flexible max	10 mm ²
Conductor cross section solid min	2.5 mm ²
Conductor cross section solid max	10 mm ²

Ratings - IEC

Connection in acc. with standard	IEC 60947-7-1
Nominal Voltage U_n	1100 V
Nominal Current I_n	57 A
Nominal cross section	10 mm ²
Short-time current	1.2 kA
Rated surge voltage	8 kV
Degree of pollution	3

Product Accessories

Cover Profile



PCC3NV	Width : 300.00 mm Thickness : 1.50 mm Length : 48.50 mm	
PCCM26NV	Width : 26.00 mm Thickness : 1.00 mm Length : 45.50 mm	
PCCM39	Width : 39.00 mm Thickness : 1.00 mm Length : 45.50 mm	

DIN Rail Perforated

CHS	Height : 15.00 mm Width : 32.00 mm Thickness : 1.50 mm	
-----	--	---

End Clamp

SCS	Height : 26.90 mm Length : 21.00 mm	
SCSN	Height : 31.00 mm Width : 8.40 mm Length : 27.00 mm	
SCUP	Height : 34.00 mm Length : 44.75 mm	
SCUSL	Height : 41.10 mm Width : 8.00 mm Length : 47.50 mm	

End Clamp		
SCUDD	Height : 50.00 mm Width : 10.00 mm Length : 55.60 mm	
SCUN	Height : 35.50 mm Width : 9.50 mm Length : 50.60 mm	
End Cover		
EPS4NV	Height : 28.50 mm Width : 2.50 mm Length : 46.00 mm	
Insertion Bridge		
ADSL-2W	Width : 20.50 mm Pitch : 13.00 mm Length : 24.00 mm	
ADSL-10W	Width : 124.50 mm Pitch : 13.00 mm Length : 24.00 mm	
ADSL-3W	Width : 33.50 mm Pitch : 13.00 mm Length : 24.00 mm	
ADSL-4W	Width : 46.50 mm Pitch : 13.00 mm Length : 24.00 mm	
ADSL-7W	Width : 85.50 mm Pitch : 13.00 mm Length : 24.00 mm	
Marker For Terminal Blocks		
LABEL KN8	Width : 8.00 mm	
Partition Plate		
KBZF	Height : 65.00 mm Width : 1.50 mm Length : 65.00 mm	

Marker carriers		
GMC	Height : 48.00 mm Width : 39.00 mm Thickness : 1.00 mm Length : 38.00 mm	
SCUDDMLH	Height : 71.50 mm Width : 10.00 mm Length : 55.60 mm	
SCUNMLH	Height : 53.50 mm Width : 9.50 mm Length : 50.60 mm	

