

CBTM6NV

Terminal Type - CBTM6NV , Feed Through Terminal Block , nominal voltage: 1100 V, nominal current: 125 A, Rated cross-section - 25 mm², connection method: Bolt connection - Nut Driver Operated, number of connections: 2, cross section: 6 mm² - 25 mm², mounting type : TS32

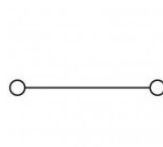
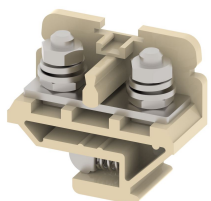

Approvals

CE

General Information

Product Name	CBTM6NV
Connection Method	Bolt Connection
Rating	1100 V/125 A/25 mm ² /2.5 Nm
HSN Number	85389000
Standard Packing Qty(in No)	25
Country Of Origin	India
Screw thread	M6

Dimensions & Weight

Width	20 mm	0.79 inch
Length	46 mm	1.81 inch
Height	42 mm	1.65 inch
Weight of std. Packing Unit	1.22 Kg	

Material Data

Insulating Material	Melamine
Standard Colour	Khakhi
Colour Variants	Red , Yellow , Blue , Black ,

Rated Conductor Size



Conductor cross section flexible min	6 mm ²
Conductor cross section flexible max	25 mm ²
Conductor cross section solid min	6 mm ²
Conductor cross section solid max	25 mm ²

Ratings - IEC

Connection in acc. with standard	IEC 60947-7-1
Nominal Voltage U_n	1100 V
Nominal Current I_n	125 A
Nominal cross section	25 mm ²
Short-time current	3 kA
Rated surge voltage	8 kV
Degree of pollution	3

Product Accessories

Cover Profile

PCC3NV	Width : 300.00 mm Thickness : 1.50 mm Length : 48.50 mm	
PCCM40	Width : 40.00 mm Thickness : 1.30 mm Length : 50.60 mm	
PCCM60	Width : 60.00 mm Thickness : 1.30 mm Length : 50.60 mm	

DIN Rail Perforated

CHS	Height : 15.00 mm Width : 32.00 mm Thickness : 1.50 mm	
-----	--	---

End Clamp

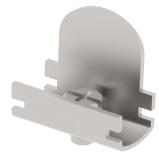
SCS	Height : 26.90 mm Length : 21.00 mm	
SCSN	Height : 31.00 mm Width : 8.40 mm Length : 27.00 mm	
SCUP	Height : 34.00 mm Length : 44.75 mm	
SCUSL	Height : 41.10 mm Width : 8.00 mm Length : 47.50 mm	

End Clamp		
SCUDD	Height : 50.00 mm Width : 10.00 mm Length : 55.60 mm	
SCUN	Height : 35.50 mm Width : 9.50 mm Length : 50.60 mm	
End Cover		
EPS4NV	Height : 28.50 mm Width : 2.50 mm Length : 46.00 mm	
Insertion Bridge		
BSL6-2W	Width : 29.50 mm Pitch : 20.00 mm Length : 29.50 mm	
BSL6-3W	Width : 49.50 mm Pitch : 20.00 mm Length : 29.50 mm	
Marker For Terminal Blocks		
LABEL KN8	Width : 8.00 mm	
Partition Plate		
KBZF	Height : 65.00 mm Width : 1.50 mm Length : 65.00 mm	
Marker carriers		
GMC	Height : 48.00 mm Width : 39.00 mm Thickness : 1.00 mm Length : 38.00 mm	
SCUDDMLH	Height : 71.50 mm Width : 10.00 mm Length : 55.60 mm	
SCUNMLH	Height : 53.50 mm Width : 9.50 mm Length : 50.60 mm	