

CST185

Terminal Type - CST185, High current feed through Terminal block, nominal voltage: 800 V, nominal current: 353 A, Rated cross-section - 185 mm², connection method: Bolt connection, number of connections: 2, cross-section: 10 mm² - 240 mm², mounting type: TS32

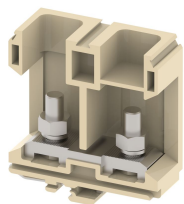

Approvals

CE

General Information

| | |
|-----------------------------|--|
| Product Name | CST185 |
| Connection Method | Bolt Connection |
| Rating | 800 V/353 A/185 mm ² /14 Nm |
| HSN Number | 85389000 |
| Standard Packing Qty(in No) | 5 |
| Country Of Origin | India |
| Screw thread | M10 |

Dimensions & Weight

| | | |
|-----------------------------|--------|-----------|
| Width | 38 mm | 1.5 inch |
| Length | 105 mm | 4.13 inch |
| Height | 113 mm | 4.45 inch |
| Weight of std. Packing Unit | 4.1 Kg | |

Material Data

| | |
|---------------------|-------------------------------|
| Insulating Material | Melamine |
| Standard Colour | Khakhi |
| Colour Variants | Red , Yellow , Blue , Black , |

Rated Conductor Size

| | |
|--------------------------------------|---------------------|
| Conductor cross section flexible min | 10 mm ² |
| Conductor cross section flexible max | 185 mm ² |
| Conductor cross section solid min | 10 mm ² |
| Conductor cross section solid max | 240 mm ² |

Ratings - IEC

| | |
|----------------------------------|---------------------|
| Connection in acc. with standard | IEC 60947-7-1 |
| Nominal Voltage U_n | 800 V |
| Nominal Current I_n | 353 A |
| Nominal cross section | 185 mm ² |
| Short-time current | 22.20 kA |
| Rated surge voltage | 8 kV |
| Degree of pollution | 3 |

Product Accessories

DIN Rail Perforated

| | | |
|-----|--|---|
| CHS | Height : 15.00 mm Width : 32.00 mm Thickness : 1.50 mm |  |
|-----|--|---|



End Clamp

| | | |
|-------|--|---|
| SCS | Height : 26.90 mm Length : 21.00 mm |  |
| SCSN | Height : 31.00 mm Width : 8.40 mm Length : 27.00 mm |  |
| SCUP | Height : 34.00 mm Length : 44.75 mm |  |
| SCUSL | Height : 41.10 mm Width : 8.00 mm Length : 47.50 mm |  |
| SCUDD | Height : 50.00 mm Width : 10.00 mm Length : 55.60 mm |  |
| SCUN | Height : 35.50 mm Width : 9.50 mm Length : 50.60 mm |  |

End Cover

| | | |
|-------|---|---|
| EP185 | Height : 105.00 mm Width : 2.70 mm Length : 113.00 mm |  |
|-------|---|---|

| Marker For Terminal Blocks | | |
|----------------------------|------------------|---|
| LABEL KN10 | Width : 10.00 mm |  |

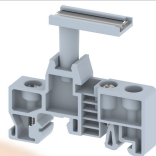
| Marker carriers | | |
|-----------------|---|---|
| GMC | Height : 48.00 mm Width : 39.00 mm Thickness : 1.00 mm Length : 38.00 mm |  |
| SCUDDMLH | Height : 71.50 mm Width : 10.00 mm Length : 55.60 mm |  |
| SCUNMLH | Height : 53.50 mm Width : 9.50 mm Length : 50.60 mm |  |

