

MCT4P4

Terminal Type -MCT4P4, Feed Through terminal block, nominal voltage: 500 V, nominal current: 32 A, Rated cross-section – 4.0 mm², connection method: Spring clamp connection, number of connections: 4, cross-section: 0.5 mm² – 4 mm², mounting type: Panel Mounted

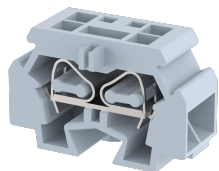

Approvals

CE

General Information

Product Name	MCT4P4
Connection Method	Spring Cage Connection
Rating	500 V/32 A/4 mm ² /NAP Nm
HSN Number	85389000
Standard Packing Qty(in No)	100
Country Of Origin	India
Screw thread	NAP

Dimensions & Weight

Width	12 mm	0.47 inch
Length	33.4 mm	1.31 inch
Height	23 mm	0.91 inch
Weight of std. Packing Unit	0.78 Kg	

Material Data

Insulating Material	Polyamide 6,6
Standard Colour	Gray
Colour Variants	Red , Yellow , Blue , Black , Green , Khakhi ,

Rated Conductor Size

Conductor cross section flexible min	0.5 mm ²
Conductor cross section flexible max	4 mm ²
Conductor cross section solid min	0.5 mm ²
Conductor cross section solid max	4 mm ²

Ratings - IEC

Connection in acc. with standard	IEC 60947-7-1
Nominal Voltage U_n	500 V
Nominal Current I_n	32 A
Nominal cross section	4 mm ²
Short-time current	0.48 kA
Rated surge voltage	6 kV
Degree of pollution	3

Ratings - ATEX

ATEX Standard	
ATEX Nominal Voltage U_n	0 V
ATEX Nominal Current I_n	0 A
ATEX Cross Sec. Flexible Max.	0 mm ²

Ratings - CSA

CSA Standard	CSA C 22.2 NO 158
B - CSA Nominal Voltage U_n	300 V
B - CSA Nominal Current I_n	20 A
B - CSA Wire Min	20 AWG
B - CSA Wire Max	12 AWG

Ratings - UL

UL Standard	
B - UL Nominal Voltage U_n	0 V
B - UL Nominal Current I_n	0 A
B - UL Wire Min	AWG
B - UL Wire Max	AWG

Product Accessories

End Cover

MEP4	Height : 23.00 mm Width : 13.80 mm Length : 33.40 mm	
------	--	---

Insertion Bridge

MSL4	Width : 11.75 mm Length : 13.90 mm	
------	---------------------------------------	---

Marker For Terminal Blocks

LABEL KN12	Width : 12.00 mm	
------------	------------------	---

