

OAT2.5

Terminal Type - OAT2.5 , Feed through terminal block with secured hinged cover, nominal voltage: 1000 V, nominal current: 41 A, Rated cross-section - 6.0 mm², connection method: Bolt connection, number of connections: 2, cross-section: 1.5 mm² - 6.0 mm², AWG: 20 - 14, mounting type: TS 35/7.5, TS 35/15 , TS 32

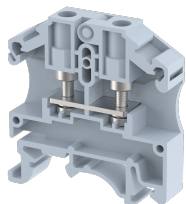

Approvals



General Information

Product Name	OAT2.5
Connection Method	Bolt Connection
Rating	1000 V/41 A/6.0 mm ² /0.5 Nm
HSN Number	85389000
Standard Packing Qty(in No)	50
Country Of Origin	INDIA
Screw thread	M3

Dimensions & Weight

Width	9 mm	0.35 inch
Length	43.5 mm	1.71 inch
Height	45.2 mm	1.78 inch
Weight of std. Packing Unit	0.69 Kg	

Material Data

Insulating Material	Polyamide 6,6
Standard Colour	Gray
Colour Variants	Red , Yellow , Blue , Black , Green , Khakhi ,

Rated Conductor Size

Conductor cross section flexible min	1.5 mm ²
Conductor cross section flexible max	6 mm ²
Conductor cross section solid min	1.5 mm ²
Conductor cross section solid max	6 mm ²

Ratings - IEC

Connection in acc. with standard	IEC 60947-7-1
Nominal Voltage U_n	1000 V
Nominal Current I_n	41 A
Nominal cross section	6.0 mm ²
Short-time current	0.3 kA
Rated surge voltage	8 kV
Degree of pollution	3

Ratings - ATEX

ATEX Standard	EN 60079-7
ATEX Nominal Voltage U_n	800 V
ATEX Nominal Current I_n	20 A
ATEX Cross Sec. Flexible Max.	2.5 mm ²

Ratings - CSA

CSA Standard	CSA C22.2 NO 158
B - CSA Nominal Voltage U_n	600 V
B - CSA Nominal Current I_n	15 A
B - CSA Wire Min	20 AWG
B - CSA Wire Max	14 AWG

Ratings - UL

UL Standard	UL 1059
B - UL Nominal Voltage U_n	600 V
B - UL Nominal Current I_n	15 A
B - UL Wire Min	20 AWG
B - UL Wire Max	14 AWG

Product Accessories

Cover Profile		
PCK3	Height : 28.00 mm Width : 58.35 mm Thickness : 1.00 mm	
Cover Profile Carrier		
UHDD	Height : 74.50 mm Thickness : 2.00 mm Length : 55.82 mm	

DIN Rail Perforated		
CHKDS	Height : 15.00 mm Width : 35.00 mm Thickness : 1.50 mm	
CHKS	Height : 7.50 mm Width : 35.00 mm Thickness : 1.00 mm	
CHS	Height : 15.00 mm Width : 32.00 mm Thickness : 1.50 mm	
DIN Rail, Unperforated		
CHKD	Height : 15.00 mm Width : 35.00 mm Thickness : 1.50 mm	
CHK	Height : 7.50 mm Width : 35.00 mm Thickness : 1.00 mm	
End Cap		
CHKENDCAP	Height : 14.00 mm Width : 9.00 mm Length : 41.50 mm	
End Clamp		
SCUP	Height : 34.00 mm Length : 44.75 mm	
SCUSL	Height : 41.10 mm Width : 8.00 mm Length : 47.50 mm	
DCKN	Height : 33.00 mm Width : 6.00 mm Length : 43.50 mm	
DCKN10	Height : 35.00 mm Width : 10.00 mm Length : 43.50 mm	

End Clamp		
SCKN	Height : 34.50 mm Width : 8.00 mm Length : 44.90 mm	
SCUN	Height : 35.50 mm Width : 9.50 mm Length : 50.60 mm	
End Cover		
OEP 2.5	Height : 33.50 mm Width : 1.50 mm Length : 43.50 mm	
Insertion Bridge		
OSL2.5-2W	Width : 15.00 mm Pitch : 9.00 mm Length : 25.50 mm	
OSL2.5-10W	Width : 87.00 mm Pitch : 9.00 mm Length : 25.50 mm	
OSL2.5-4W	Width : 33.00 mm Pitch : 9.00 mm Length : 25.50 mm	
OSL2.5-5W	Width : 48.00 mm Pitch : 9.00 mm Length : 25.50 mm	
Marker For Terminal Blocks		
LABEL KN6.5	Width : 6.70 mm	
Marker carriers		
SCUNMLH	Height : 53.50 mm Width : 9.50 mm Length : 50.60 mm	
DCKNMLH	Height : 45.50 mm Width : 6.00 mm Length : 43.50 mm	
SCKNMLH	Height : 45.50 mm Width : 8.00 mm Length : 44.90 mm	