

OAT6

Terminal Type - OAT6 , Feed through terminal block with secured hinged cover, nominal voltage: 1000 V, nominal current: 57 A, connection method: Bolt connection, number of connections: 2, cross section: 1.5 mm² - 10 mm², AWG: 20 - 10, width: 11 mm , length: 43.5 mm , height : 51 mm , mounting type: TS 35/7.5, TS 35/15 , TS 32

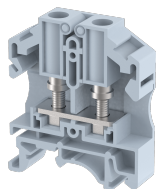

Approvals



General Information

Product Name	OAT6
Connection Method	Bolt Connection
Rating	1000 V/57 A/10 mm ² /1.5 Nm
HSN Number	85389000
Standard Packing Qty(in No)	100
Country Of Origin	India
Screw thread	M4

Dimensions & Weight

Width	11 mm	0.43 inch
Length	43.5 mm	1.71 inch
Height	51 mm	2.01 inch
Weight of std. Packing Unit	2.07 Kg	

Material Data

Insulating Material	Polyamide 6,6
Standard Colour	Gray
Colour Variants	Red , Yellow , Blue , Black , Green , Khakhi ,

Rated Conductor Size

Conductor cross section flexible min	0.5 mm ²
Conductor cross section flexible max	6 mm ²
Conductor cross section solid min	0.5 mm ²
Conductor cross section solid max	6 mm ²

Ratings - IEC

Connection in acc. with standard	IEC 60947-7-1
Nominal Voltage U_n	1000 V
Nominal Current I_n	57 A
Nominal cross section	10 mm ²
Short-time current	1.2 kA
Rated surge voltage	8 kV
Degree of pollution	3

Ratings - ATEX

ATEX Standard	EN 60079-7
ATEX Nominal Voltage U_n	630 V
ATEX Nominal Current I_n	28 A
ATEX Cross Sec. Flexible Max.	6 mm ²

Ratings - CSA

CSA Standard	CSA C22.2 NO 158
B - CSA Nominal Voltage U_n	600 V
B - CSA Nominal Current I_n	30 A
B - CSA Wire Min	20 AWG
B - CSA Wire Max	10 AWG

Ratings - UL

UL Standard	UL 1059
B - UL Nominal Voltage U_n	600 V
B - UL Nominal Current I_n	30 A
B - UL Wire Min	20 AWG
B - UL Wire Max	10 AWG

Product Accessories

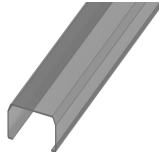
Cover Profile		
PCK3	Height : 28.00 mm Width : 58.35 mm Thickness : 1.00 mm	

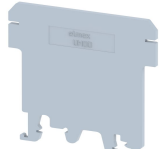
Cover Profile Carrier		
UHDD	Height : 74.50 mm Thickness : 2.00 mm Length : 55.82 mm	

DIN Rail Perforated		
CHKDS	Height : 15.00 mm Width : 35.00 mm Thickness : 1.50 mm	
CHKS	Height : 7.50 mm Width : 35.00 mm Thickness : 1.00 mm	
CHS	Height : 15.00 mm Width : 32.00 mm Thickness : 1.50 mm	
DIN Rail, Unperforated		
CHKD	Height : 15.00 mm Width : 35.00 mm Thickness : 1.50 mm	
CHK	Height : 7.50 mm Width : 35.00 mm Thickness : 1.00 mm	
End Cap		
CHKENDCAP	Height : 14.00 mm Width : 9.00 mm Length : 41.50 mm	
End Clamp		
SCUP	Height : 34.00 mm Length : 44.75 mm	
SCUSL	Height : 41.10 mm Width : 8.00 mm Length : 47.50 mm	
SCUDD	Height : 50.00 mm Width : 10.00 mm Length : 55.60 mm	
DCKN	Height : 33.00 mm Width : 6.00 mm Length : 43.50 mm	

End Clamp		
DCKN10	Height : 35.00 mm Width : 10.00 mm Length : 43.50 mm	
SCKN	Height : 34.50 mm Width : 8.00 mm Length : 44.90 mm	
SCUN	Height : 35.50 mm Width : 9.50 mm Length : 50.60 mm	

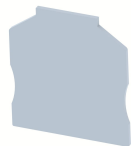
End Cover		
OEP 6	Height : 39.50 mm Width : 1.50 mm Length : 43.50 mm	

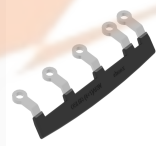
Insertion Bridge		
OSL6-2W	Width : 17.50 mm Pitch : 11.00 mm Length : 25.50 mm	
OSL6R(4+1)ARW	Width : 83.50 mm Pitch : 22.00 mm Length : 25.30 mm	

Marker For Terminal Blocks		
LABEL KN 9	Width : 9.00 mm	

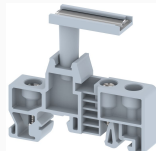
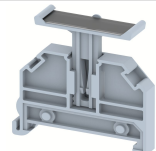
Marker carriers		
SCUDDMLH	Height : 71.50 mm Width : 10.00 mm Length : 55.60 mm	
SCUNMLH	Height : 53.50 mm Width : 9.50 mm Length : 50.60 mm	
DCKNMLH	Height : 45.50 mm Width : 6.00 mm Length : 43.50 mm	

Marker carriers

SCKNMLH	Height : 45.50 mm Width : 8.00 mm Length : 44.90 mm	
---------	---	---

