

SQF4

Terminal Type - SQF4 , Fuse Terminal block, nominal voltage: 1000 V, nominal current: 10 A, Rated cross section: 4.0 mm² ,suitable size of cartridge fuse : 5X20 mm , connection method: Spring Cage connection, number of connections: 2, cross section: 0.08 mm² - 6 mm², AWG: 24-10 , mounting type: TS 35/7.5, TS 35/15

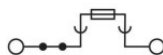

Approvals

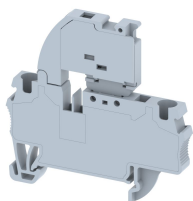

General Information

Product Name	SQF4
Connection Method	Spring Cage Connection
Rating	1000 V/10 A/4 mm ² /NAP Nm
HSN Number	85389000
Standard Packing Qty(in No)	100
Country Of Origin	India
Screw thread	NAP

Dimensions & Weight

Width	6 mm	0.24 inch
Length	62.4 mm	2.46 inch
Height	61.2 mm	2.41 inch
Weight of std. Packing Unit	2.01 Kg	

Material Data

Insulating Material	Polyamide 6,6
Standard Colour	Gray
Colour Variants	Red , Yellow , Blue , Black , Khakhi ,

Rated Conductor Size

Conductor cross section flexible min	0.14 mm ²
Conductor cross section flexible max	4 mm ²
Conductor cross section solid min	0.08 mm ²
Conductor cross section solid max	6 mm ²

Ratings - IEC

Connection in acc. with standard	IEC 60947-7-1 , IEC 60947-7-3
Nominal Voltage U_n	1000 V
Nominal Current I_n	10 A
Nominal cross section	4 mm ²
Short-time current	NAP kA
Rated surge voltage	8 kV
Degree of pollution	3

Ratings - ATEX

ATEX Standard	
ATEX Nominal Voltage U_n	0 V
ATEX Nominal Current I_n	A
ATEX Cross Sec. Flexible Max.	mm ²



Ratings - CSA

CSA Standard	CSA C22.2 NO 158
B - CSA Nominal Voltage U_n	600 V
B - CSA Nominal Current I_n	6.3 A
B - CSA Wire Min	24 AWG
B - CSA Wire Max	10 AWG

Ratings - UL

UL Standard	UL 1059
B - UL Nominal Voltage U_n	600 V
B - UL Nominal Current I_n	6.3 A
B - UL Wire Min	24 AWG
B - UL Wire Max	10 AWG

Product Accessories

DIN Rail Perforated		
CHKDS	Height : 15.00 mm Width : 35.00 mm Thickness : 1.50 mm	
CHKS	Height : 7.50 mm Width : 35.00 mm Thickness : 1.00 mm	

DIN Rail, Unperforated		
CHKD	Height : 15.00 mm Width : 35.00 mm Thickness : 1.50 mm	
CHK	Height : 7.50 mm Width : 35.00 mm Thickness : 1.00 mm	
End Cap		
CHKENDCAP	Height : 14.00 mm Width : 9.00 mm Length : 41.50 mm	
End Clamp		
SCUP	Height : 34.00 mm Length : 44.75 mm	
SCUSL	Height : 41.10 mm Width : 8.00 mm Length : 47.50 mm	
SCUDD	Height : 50.00 mm Width : 10.00 mm Length : 55.60 mm	
DCKN	Height : 33.00 mm Width : 6.00 mm Length : 43.50 mm	
DCKN10	Height : 35.00 mm Width : 10.00 mm Length : 43.50 mm	
SCKN	Height : 34.50 mm Width : 8.00 mm Length : 44.90 mm	
SCUN	Height : 35.50 mm Width : 9.50 mm Length : 50.60 mm	

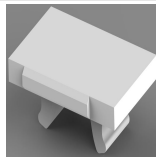
Marker For Terminal Blocks		
LABEL KN5.5	Width : 6.00 mm	

Partition Plate		
DBF-6	Height : 75.00 mm Width : 3.00 mm Length : 85.00 mm	

Plug-in Bridge/Jumper		
SLPU6-2W	Height : 26.00 mm Width : 10.15 mm Pitch : 6.00 mm	
SLPU6-10W	Height : 26.00 mm Width : 58.15 mm Pitch : 6.00 mm	
SLPU6-3W	Height : 26.00 mm Width : 16.15 mm Pitch : 6.00 mm	
SLPU6-4W	Height : 26.00 mm Width : 22.15 mm Pitch : 6.00 mm	
SLPU6-5W	Height : 26.00 mm Width : 28.15 mm Pitch : 6.00 mm	
SLPU6-6W	Height : 26.00 mm Width : 34.15 mm Pitch : 6.00 mm	

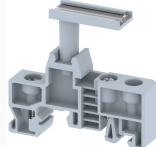
Marker carriers		
SCUDDMLH	Height : 71.50 mm Width : 10.00 mm Length : 55.60 mm	
SCUNMLH	Height : 53.50 mm Width : 9.50 mm Length : 50.60 mm	

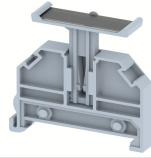
Marker carriers		
DCKNMLH	Height : 45.50 mm Width : 6.00 mm Length : 43.50 mm	
SCKNMLH	Height : 45.50 mm Width : 8.00 mm Length : 44.90 mm	