

SQM2.5

Terminal Type - SQM2.5 , Mini and Micro feed through terminal block, nominal voltage: 1000 V, nominal current: 24 A, Rated cross-section: 2.5 mm² , connection method: Spring Cage connection, number of connections: 2, cross-section: 0.08 mm² - 4 mm², AWG : 24-12 , mounting type: TS 15

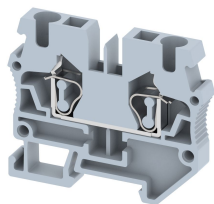

Approvals



General Information

Product Name	SQM2.5
Connection Method	Spring Cage Connection
Rating	1000 V/24 A/2.5 mm ² / Nm
HSN Number	85389000
Standard Packing Qty(in No)	100
Country Of Origin	India
Screw thread	NAP

Dimensions & Weight

Width	5 mm	0.2 inch
Length	39.8 mm	1.57 inch
Height	32.7 mm	1.29 inch
Weight of std. Packing Unit	0.5 Kg	

Material Data

Insulating Material	Polyamide 6,6
Standard Colour	Gray
Colour Variants	Red , Yellow , Blue , Black , Green , Khakhi ,

Rated Conductor Size

Conductor cross section flexible min	0.14 mm ²
Conductor cross section flexible max	2.5 mm ²
Conductor cross section solid min	0.08 mm ²
Conductor cross section solid max	4 mm ²

Ratings - IEC

Connection in acc. with standard	IEC 60947-7-1
Nominal Voltage U_n	1000 V
Nominal Current I_n	24 A
Nominal cross section	2.5 mm ²
Short-time current	0.3 kA
Rated surge voltage	8 kV
Degree of pollution	3

Ratings - ATEX

ATEX Standard	
ATEX Nominal Voltage U_n	0 V
ATEX Nominal Current I_n	A
ATEX Cross Sec. Flexible Max.	mm ²

Ratings - CSA

CSA Standard	CSA C22.2 NO 158
B - CSA Nominal Voltage U_n	600 V
B - CSA Nominal Current I_n	20 A
B - CSA Wire Min	24 AWG
B - CSA Wire Max	12 AWG

Ratings - UL

UL Standard	UL 1059
B - UL Nominal Voltage U_n	600 V
B - UL Nominal Current I_n	20 A
B - UL Wire Min	24 AWG
B - UL Wire Max	12 AWG

Product Accessories

DIN Rail Perforated

CHM	Height : 5.00 mm Width : 15.00 mm Thickness : 1.00 mm	
-----	---	---

End Clamp

SCMN	Height : 18.00 mm Width : 6.10 mm Length : 23.50 mm	
------	---	---

End Cover		
CSPM2.5	Height : 24.90 mm Width : 2.00 mm Length : 39.80 mm	
Marker For Terminal Blocks		
LABEL KN5	Width : 5.00 mm	
Plug-in Bridge/Jumper		
SLPU5-10W	Height : 26.00 mm Width : 49.15 mm Pitch : 5.00 mm	
SLPU5-2W	Height : 26.00 mm Width : 9.15 mm Pitch : 5.00 mm	
SLPU5-3W	Height : 26.00 mm Width : 14.15 mm Pitch : 5.00 mm	
SLPU5-4W	Height : 26.00 mm Width : 19.15 mm Pitch : 5.00 mm	
SLPU5-5W	Height : 26.00 mm Width : 24.15 mm Pitch : 5.00 mm	
SLPU5-6W	Height : 26.00 mm Width : 29.15 mm Pitch : 5.00 mm	
SLPU5-7W	Height : 26.00 mm Width : 34.15 mm Pitch : 5.00 mm	