

CATM3

Terminal Type - CATM3, Feed Through Terminal Block, nominal voltage: 1100 V, nominal current: 32 A, Rated cross-section - 4.0 mm², connection method: Bolt Connection - Screwdriver Operated, number of connections: 2, cross-section: 2.5 mm² - 4 mm², mounting type: TS32

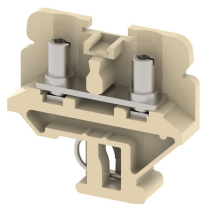

Approvals

CE

General Information

Product Name	CATM3
Connection Method	Bolt Connection
Rating	1100 V/32 A/4 mm ² /0.5 Nm
HSN Number	85389000
Standard Packing Qty(in No)	50
Country Of Origin	India
Screw thread	M3

Dimensions & Weight

Width	10 mm	0.39 inch
Length	46 mm	1.81 inch
Height	42 mm	1.65 inch
Weight of std. Packing Unit	0.97 Kg	

Material Data

Insulating Material	Melamine
Standard Colour	Khakhi
Colour Variants	Red , Yellow , Blue , Black , Green ,

Rated Conductor Size

Conductor cross section flexible min	2.5 mm ²
Conductor cross section flexible max	4 mm ²
Conductor cross section solid min	2.5 mm ²
Conductor cross section solid max	4 mm ²

Ratings - IEC

Connection in acc. with standard	IEC 60947-7-1
Nominal Voltage U_n	1100 V
Nominal Current I_n	32 A
Nominal cross section	4 mm ²
Short-time current	0.48 kA
Rated surge voltage	8 kV
Degree of pollution	3

