

CBTM6NV

Terminal Type - CBTM6NV , Feed Through Terminal Block , nominal voltage: 1100 V, nominal current: 125 A, Rated cross-section - 25 mm², connection method: Bolt connection - Nut Driver Operated, number of connections: 2, cross section: 6 mm² - 25 mm², mounting type : TS32

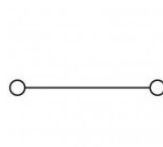
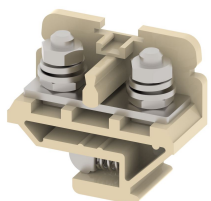

Approvals

CE

General Information

Product Name	CBTM6NV
Connection Method	Bolt Connection
Rating	1100 V/125 A/25 mm ² /2.5 Nm
HSN Number	85389000
Standard Packing Qty(in No)	25
Country Of Origin	India
Screw thread	M6

Dimensions & Weight

Width	20 mm	0.79 inch
Length	46 mm	1.81 inch
Height	42 mm	1.65 inch
Weight of std. Packing Unit	1.22 Kg	

Material Data

Insulating Material	Melamine
Standard Colour	Khakhi
Colour Variants	Red , Yellow , Blue , Black ,

Rated Conductor Size

Conductor cross section flexible min	6 mm ²
Conductor cross section flexible max	25 mm ²
Conductor cross section solid min	6 mm ²
Conductor cross section solid max	25 mm ²

Ratings - IEC

Connection in acc. with standard	IEC 60947-7-1
Nominal Voltage U_n	1100 V
Nominal Current I_n	125 A
Nominal cross section	25 mm ²
Short-time current	3 kA
Rated surge voltage	8 kV
Degree of pollution	3

