

OAT6

Terminal Type - OAT6 , Feed through terminal block with secured hinged cover, nominal voltage: 1000 V, nominal current: 57 A, connection method: Bolt connection, number of connections: 2, cross section: 1.5 mm² - 10 mm², AWG: 20 - 10, width: 11 mm , length: 43.5 mm , height : 51 mm , mounting type: TS 35/7.5, TS 35/15 , TS 32

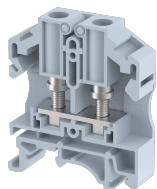

Approvals



General Information

| | |
|-----------------------------|--|
| Product Name | OAT6 |
| Connection Method | Bolt Connection |
| Rating | 1000 V/57 A/10 mm ² /1.5 Nm |
| HSN Number | 85389000 |
| Standard Packing Qty(in No) | 100 |
| Country Of Origin | India |
| Screw thread | M4 |

Dimensions & Weight

| | | |
|-----------------------------|---------|-----------|
| Width | 11 mm | 0.43 inch |
| Length | 43.5 mm | 1.71 inch |
| Height | 51 mm | 2.01 inch |
| Weight of std. Packing Unit | 2.07 Kg | |

Material Data

| | |
|---------------------|--|
| Insulating Material | Polyamide 6,6 |
| Standard Colour | Gray |
| Colour Variants | Red , Yellow , Blue , Black , Green , Khakhi , |

Rated Conductor Size

| | |
|--------------------------------------|---------------------|
| Conductor cross section flexible min | 0.5 mm ² |
| Conductor cross section flexible max | 6 mm ² |
| Conductor cross section solid min | 0.5 mm ² |
| Conductor cross section solid max | 6 mm ² |

Ratings - IEC

| | |
|----------------------------------|--------------------|
| Connection in acc. with standard | IEC 60947-7-1 |
| Nominal Voltage U_n | 1000 V |
| Nominal Current I_n | 57 A |
| Nominal cross section | 10 mm ² |
| Short-time current | 1.2 kA |
| Rated surge voltage | 8 kV |
| Degree of pollution | 3 |

Ratings - ATEX

| | |
|-------------------------------|-------------------|
| ATEX Standard | EN 60079-7 |
| ATEX Nominal Voltage U_n | 630 V |
| ATEX Nominal Current I_n | 28 A |
| ATEX Cross Sec. Flexible Max. | 6 mm ² |

Ratings - CSA

| | |
|-------------------------------|------------------|
| CSA Standard | CSA C22.2 NO 158 |
| B - CSA Nominal Voltage U_N | 600 V |
| B - CSA Nominal Current I_N | 30 A |
| B - CSA Wire Min | 20 AWG |
| B - CSA Wire Max | 10 AWG |

Ratings - UL

| | |
|------------------------------|---------|
| UL Standard | UL 1059 |
| B - UL Nominal Voltage U_N | 600 V |
| B - UL Nominal Current I_N | 30 A |
| B - UL Wire Min | 20 AWG |
| B - UL Wire Max | 10 AWG |